

INDICATOR INSERT

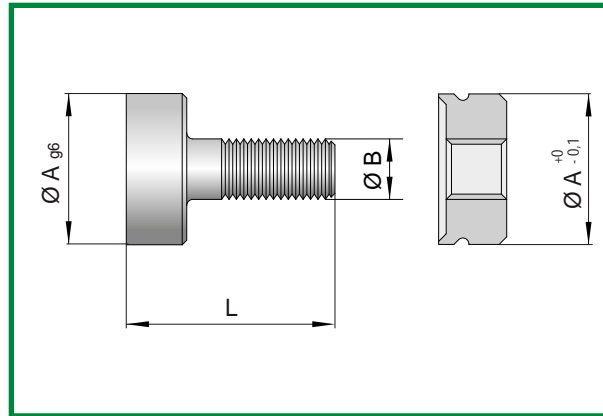

CODE	A	B	L	L1
II-6	6	M3x0,35	10	10 min.
II-8	8	M4x0,35	14	14 min.
II-10	10	M4x0,35	14	14 min.

Mat.: AISI 420B
Hardness: 50÷55 HRC

APPLICATION PROCESS

- 1) Build the seat according to the drawing;
- 2) Fit the threaded bush in with the cold-heading edge upwards;
- 3) Cold-head the border with a drift of the same diameter;
- 4) Fit the spring in and screw the insert.

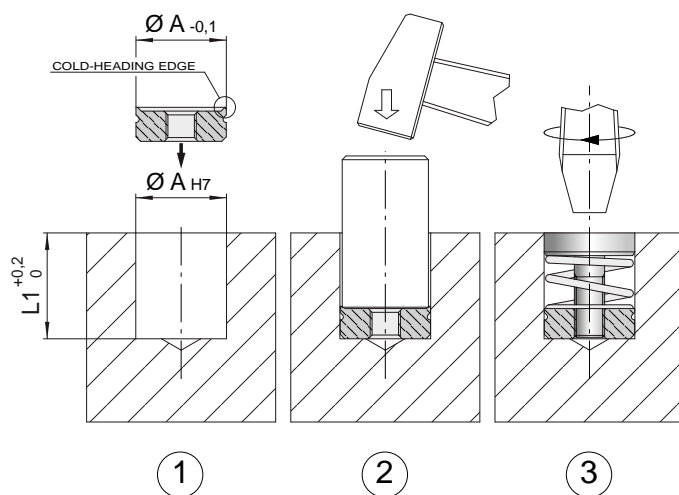

APPLICATION EXAMPLES

