

ERMANNNO BALZI

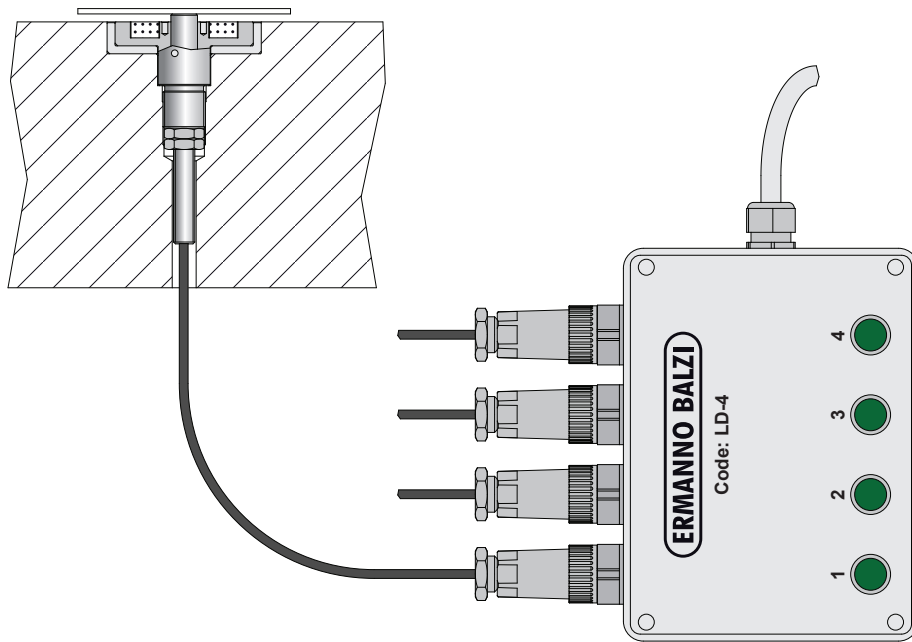

SENSOR MODULE

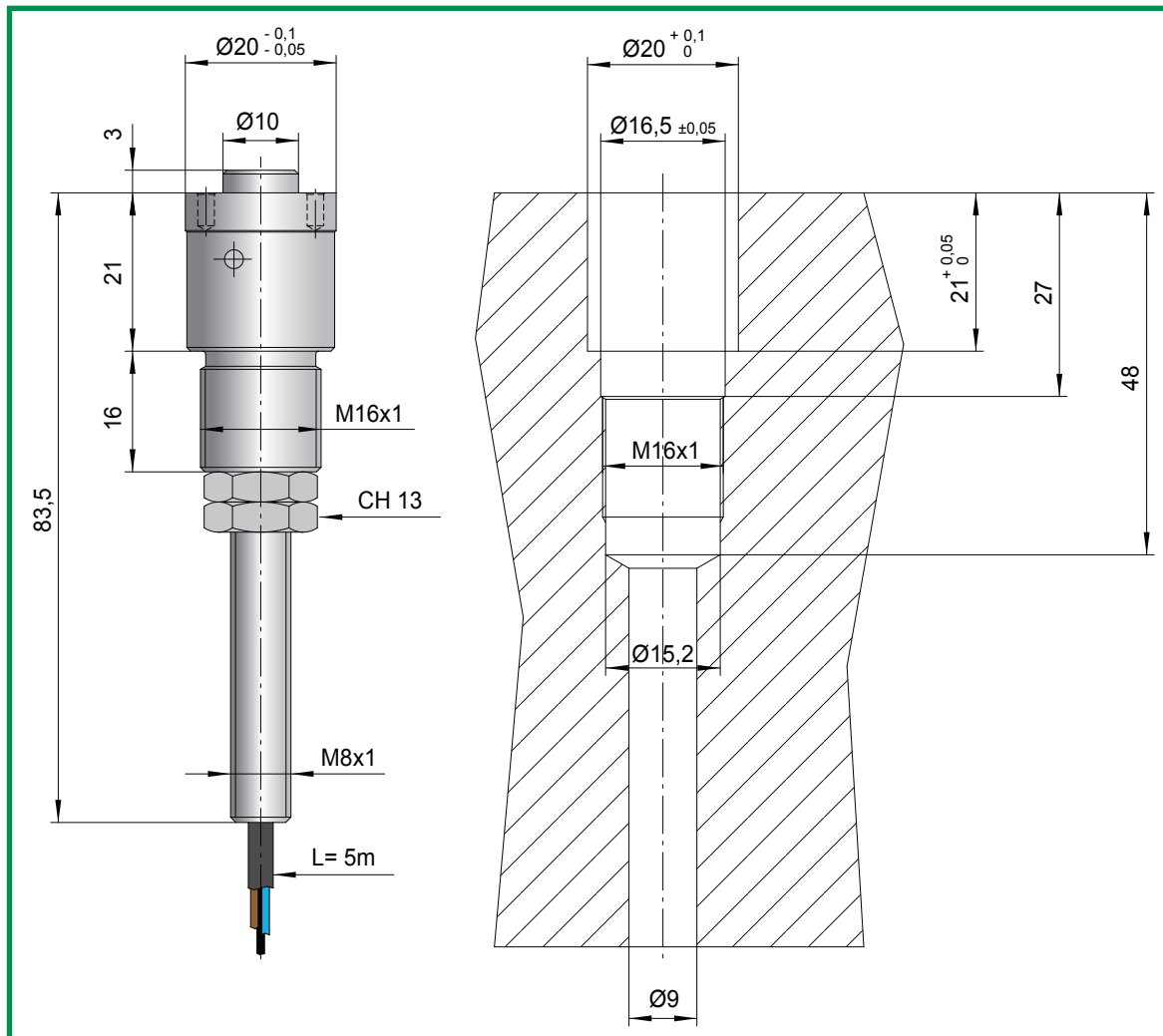

CODE: **SM-20**

CHARACTERISTICS

- 1) EASY TO APPLY;
- 2) ADJUSTABLE READING DISTANCE BETWEEN 0 AND 2 mm FROM PARTING LINE (standard setting 1,5 mm)
- 3) MAXIMUM WORKING TEMPERATURE 120 °C.

SENSOR MODULE WHIT MAGNET

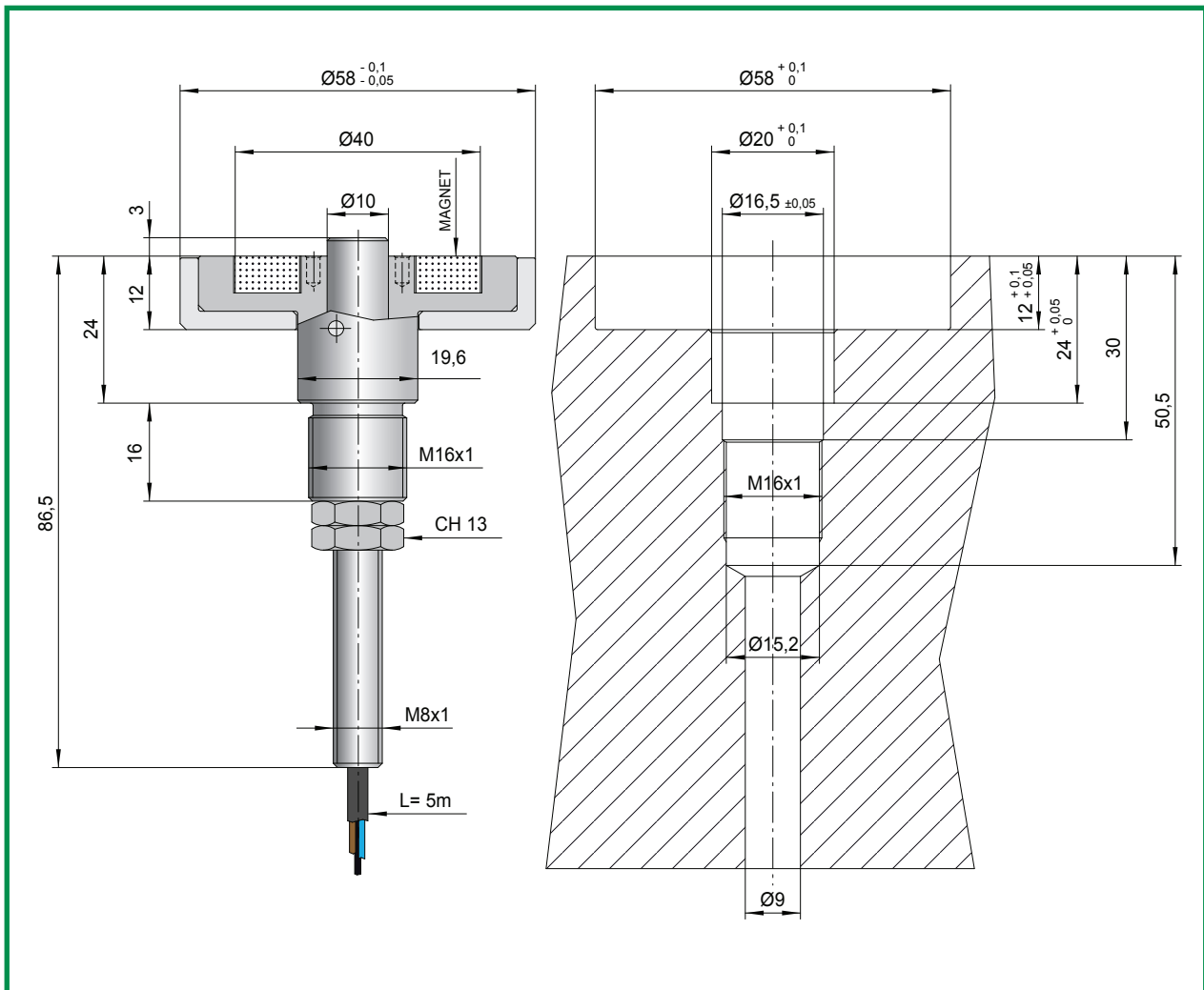

CODE: **SMM-19**

CHARACTERISTICS

- 1) EASY TO APPLY;
- 2) MAGNET FORCE 19 Kgf;
- 3) ADJUSTABLE READING DISTANCE BETWEEN 0 AND 2 mm FROM PARTING LINE (standard setting 1,5 mm);
- 4) MAXIMUM WORKING TEMPERATURE 120 °C.

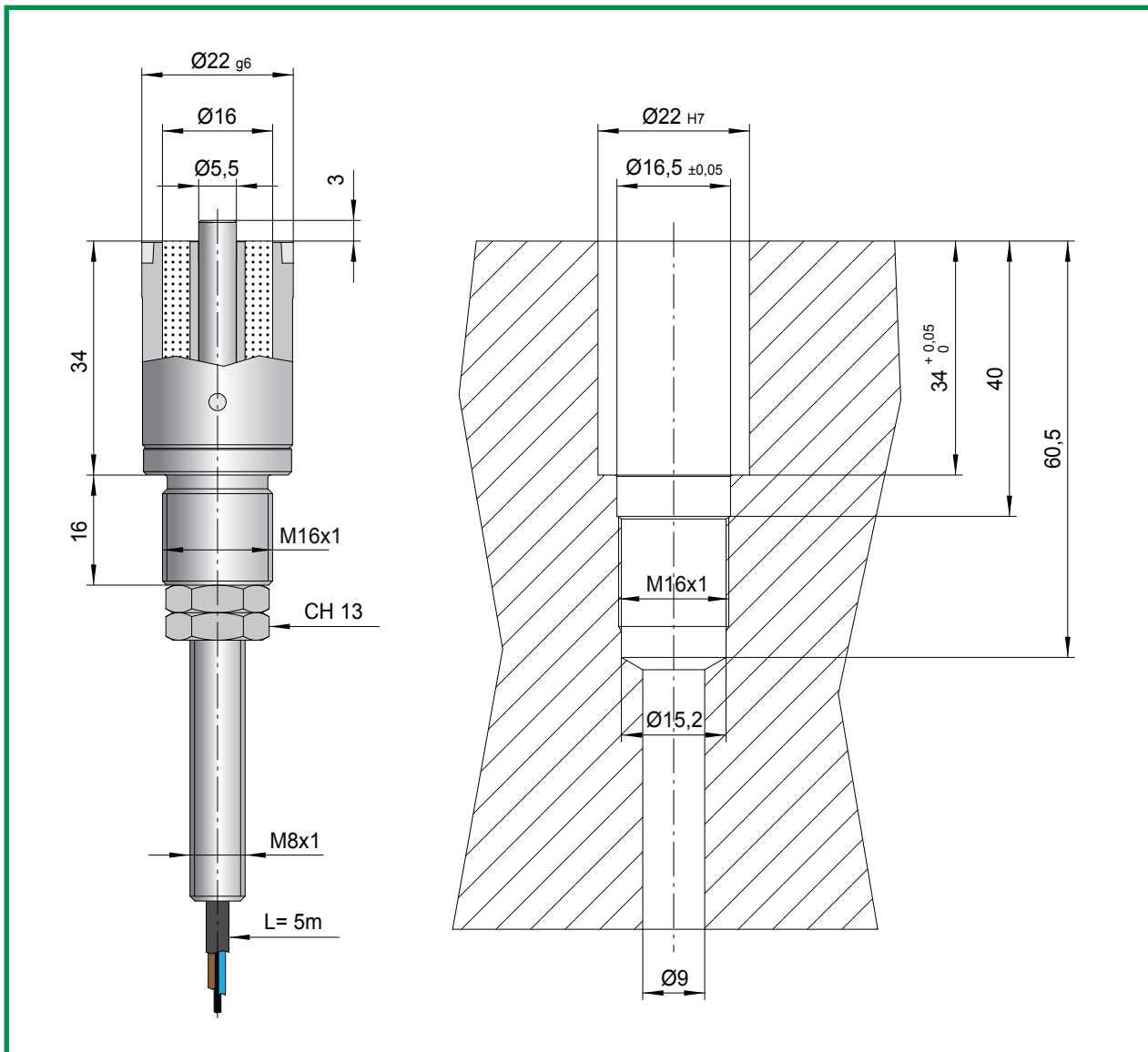

CODE: **SMM-5**

CHARACTERISTICS

- 1) EASY TO APPLY;
- 2) MAGNET FORCE 5 Kgf;
- 3) ADJUSTABLE READING DISTANCE BETWEEN 0 AND 2 mm FROM PARTING LINE (standard setting 1,5 mm);
- 4) MAXIMUM WORKING TEMPERATURE 120 °C.

KEY FOR SENSOR MODULE

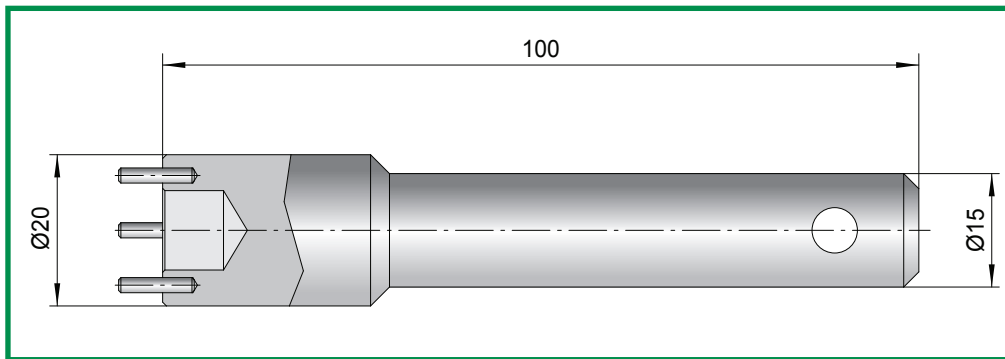

CODE: **SM-C1**

CODE	SM-20	SMM-19
SM-C1	✓	✓

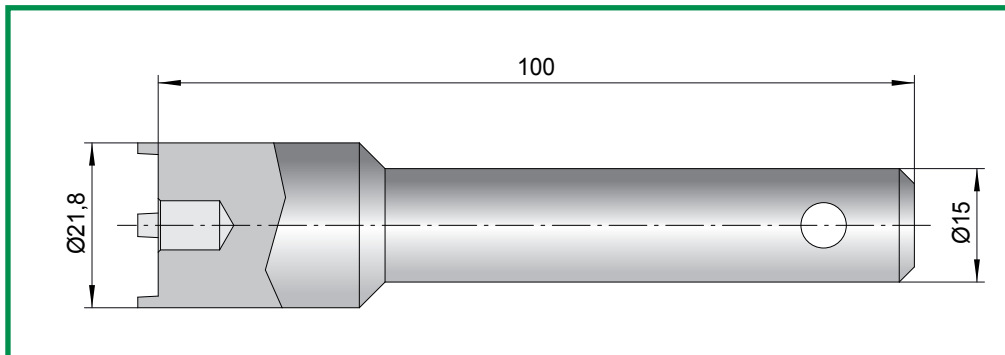

CODE: **SM-C2**

CODE	SMM-5
SM-C2	✓

CODE	INDUCTIVE SENSOR PNP		CABLE SENSOR	
	SM-IS	Contact type	NO	BROWN
Operating voltage Ue DC		24.0 V	BLUE	0Vdc
Operating voltage range		Da 10.0 a 30.0 V	BLACK	load (RELÉ)
Operating current		200mA		
Switching freq. f max		1500Hz		
Sensor type		Inductive PNP		
Voltage drop static max		2.5V		
Temperature range		+120°C / -25°C		
Polarity reversal protected		YES		
Degree of protec housing		IP67		
Degree of protec cable out		IP60		

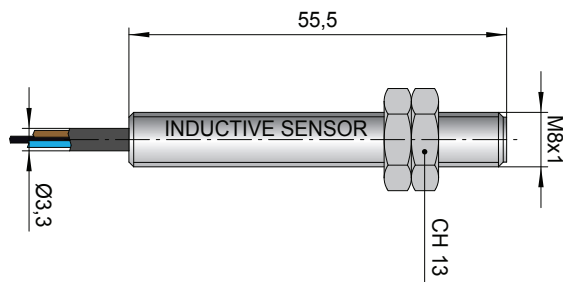

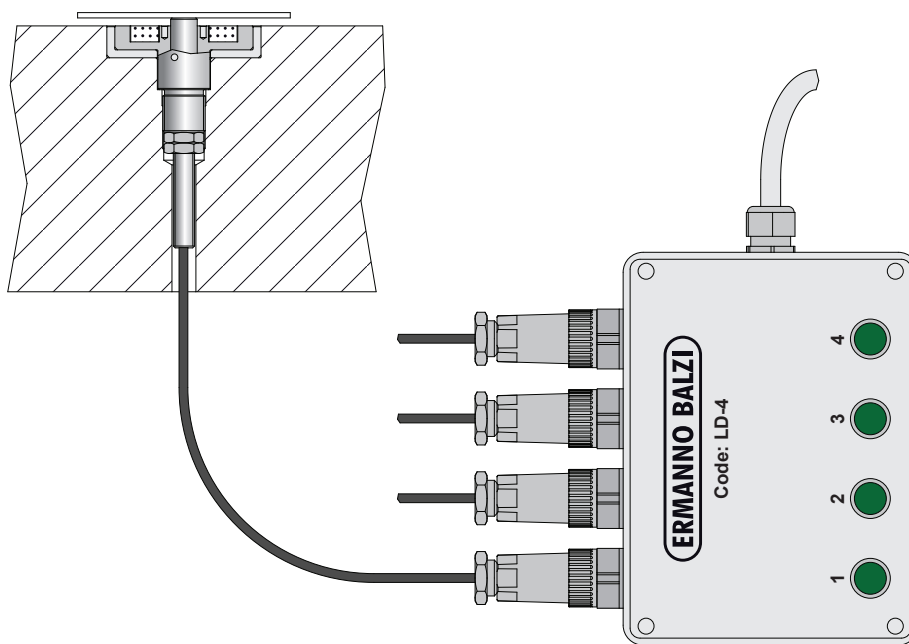

OFF- led off with no signal

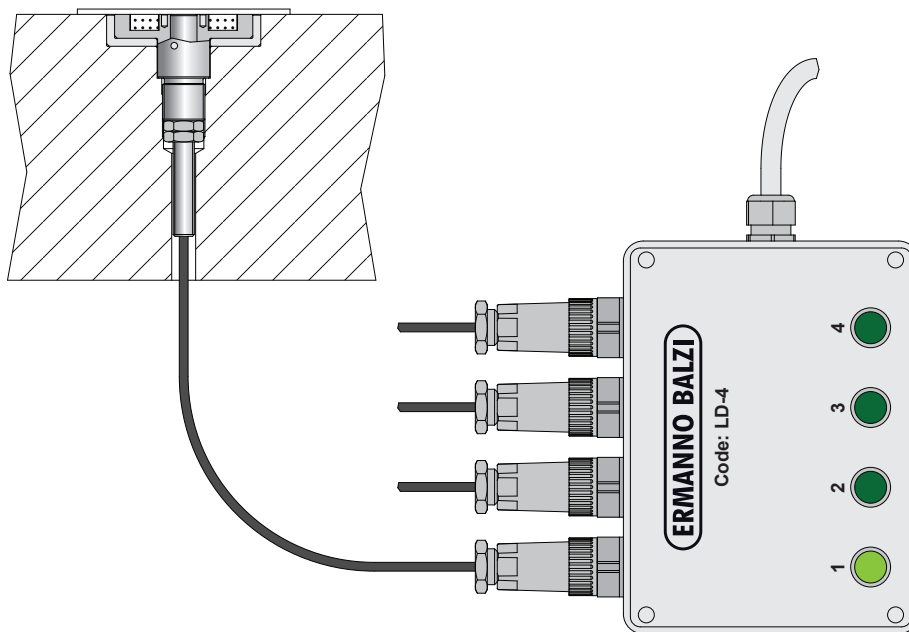

ON- led on with signal present

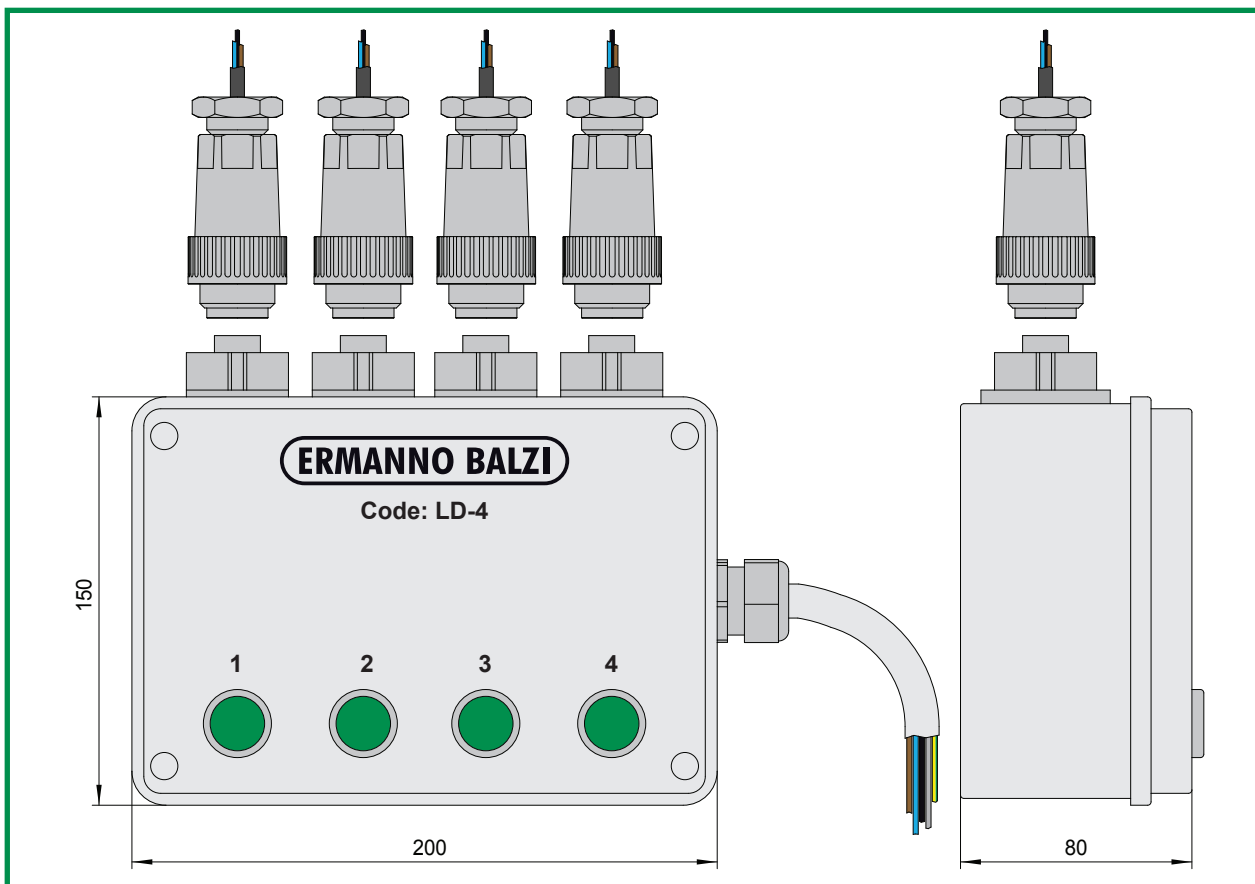

CODE: **LD-..**

CODE	N° CONNECTORS
LD-2	2
LD-4	4
LD-6	6

ELECTRICAL DATA

CABLE 5G 1,5

BROWN	+24Vdc
BLUE	0Vdc
BLACK	RETURN +24Vdc AL PLC (OK)
GRAY	RETURN +24Vdc AL PLC (NOT OK)
YELLOW/GREEN	NOT CONNECTED

CHARACTERISTICS

- 1) UP TO N°6 SENSORS CONNECTED;
- 2) ENABLING SIGNAL TO IMM WHEN ALL SENSORS ARE ACTIVATED;
- 3) NON ENABLING SIGNAL TO IMM WITH AT LEAST ONE SENSOR NOT ACTIVATED;
- 4) LED FOR SWITCH STATE INDICATOR.

LOGIC DISTRIBUTOR ELECTRICAL DIAGRAM

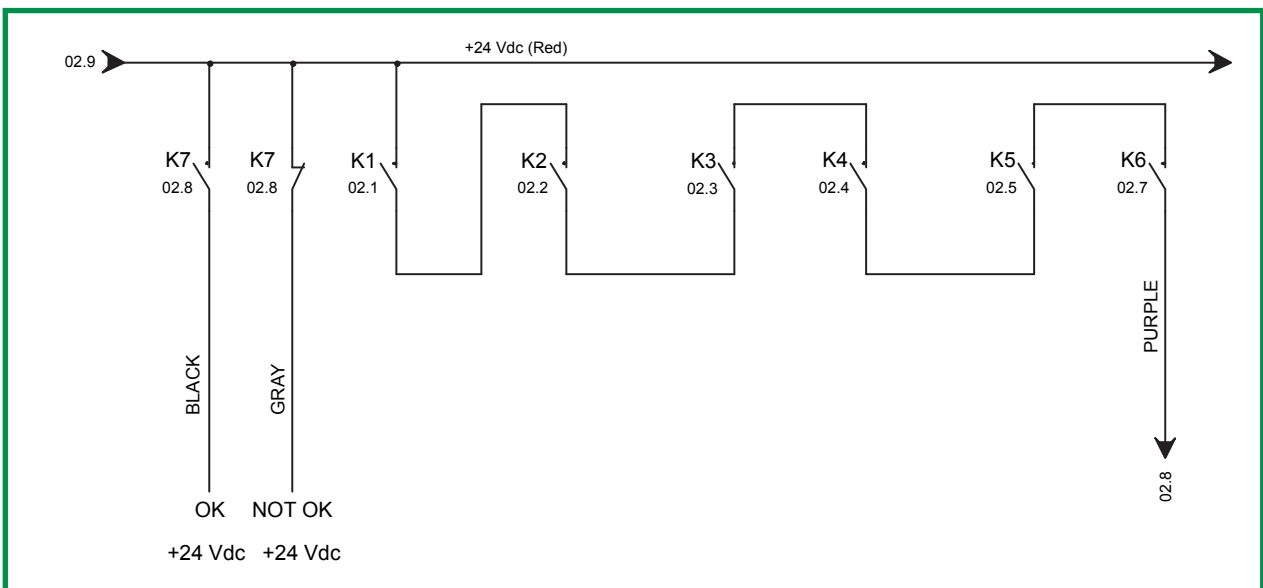
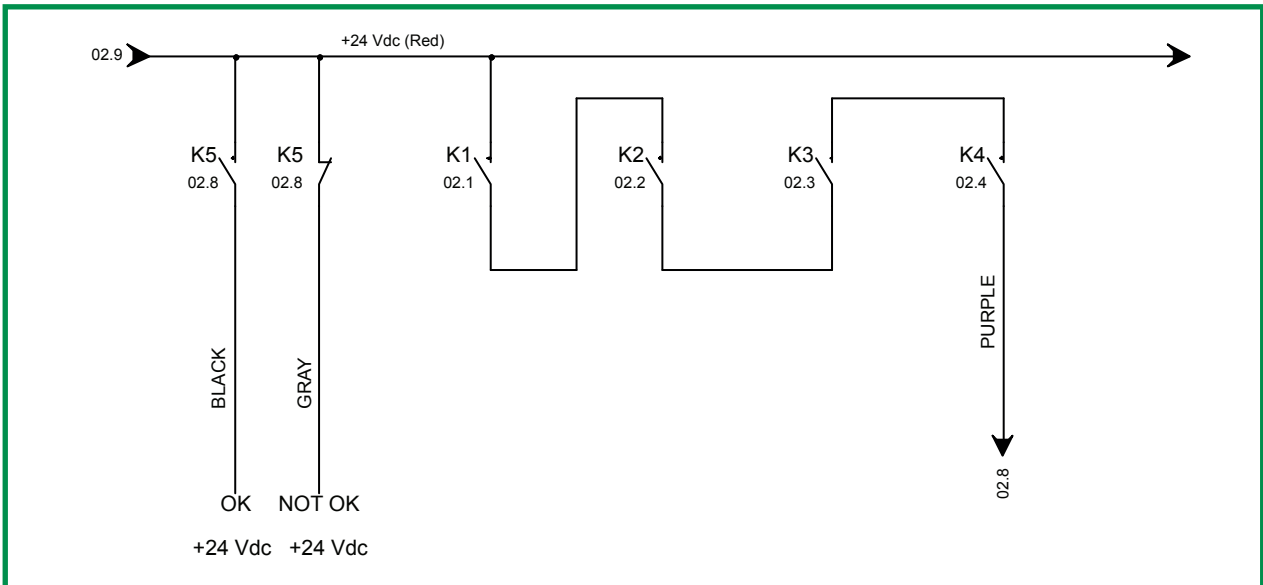
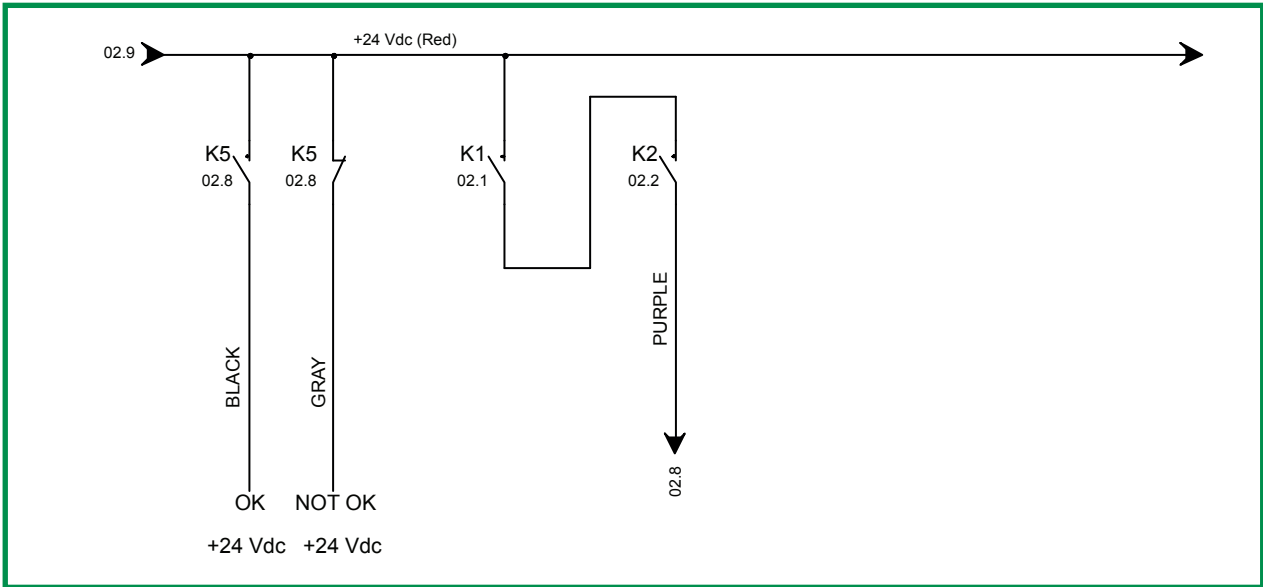

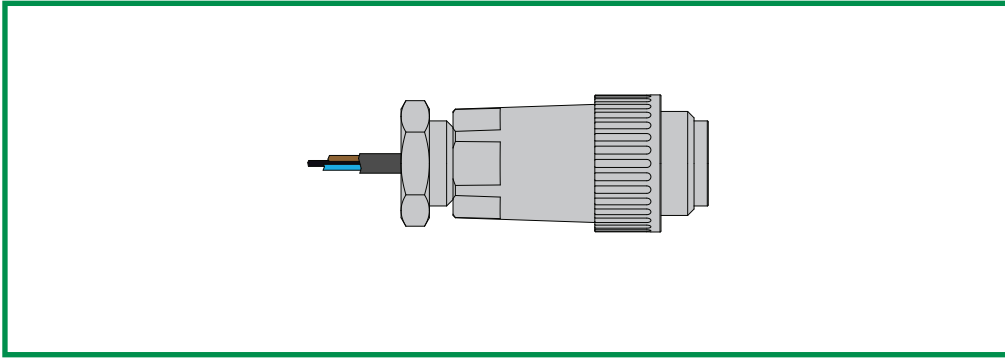

CODE: **SM-CE**

ELECTRICAL CONNECTION

BRAWN	PIN-1
BLUE	PIN-2
BLACK	PIN-3

SETTING SENSOR MODULE

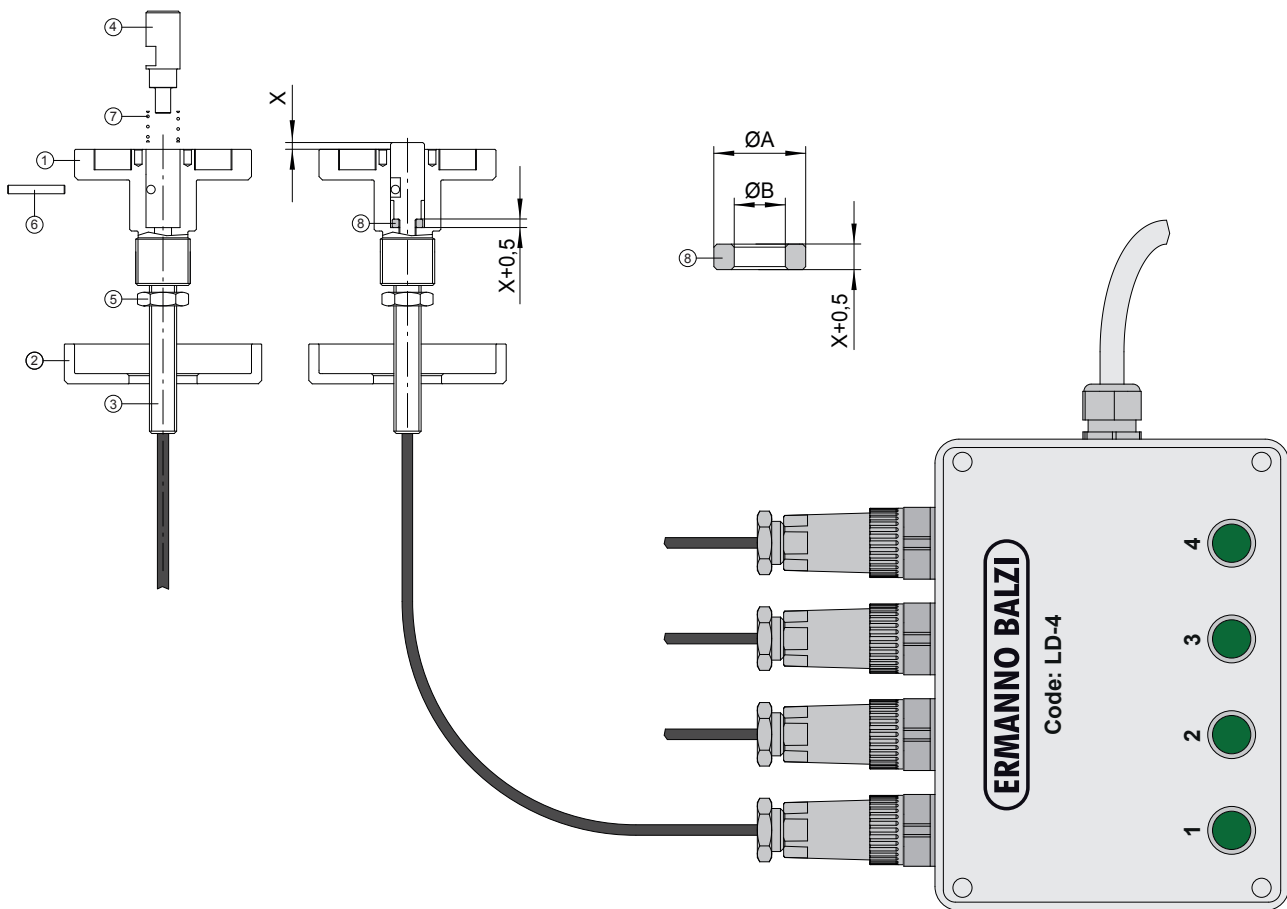

- CONNECT THE SENSOR TO THE LOGIC DISTRIBUTOR LD-..;
- TURN ON THE LOGIC DISTRIBUTOR;
- LOOSEN THE DOWEL 5;
- PULL OUT THE FLANGE 2;
- EXTRACT THE PIN 6, THE SHAFT 4 AND THE SPRING 7;
- INSERT THE SPACER 9 HAVING THICKNESS $X+0,5\text{mm}$ ($X=\text{READING DISTANCE}$);
- INSERT THE SHAFT 4;
- HOLDING THE SENSOR 3 ROTATE CLOCKWISE THE BODY 1 TILL THE A GREEN LIGHT ON THE LOGIC DISTRIBUTOR LD-.. SWITC ON ;
- SCREW AND TIGHTEN THE DOWEL 5;
- REMOVE THE SPACER 8;
- ASSEMBLY THE PARTS 7, 4, 6 AND 2.

CODE	A	B
SM-20	9,5	5
SMM-19	9,5	5
SMM-5	5,45	4,1

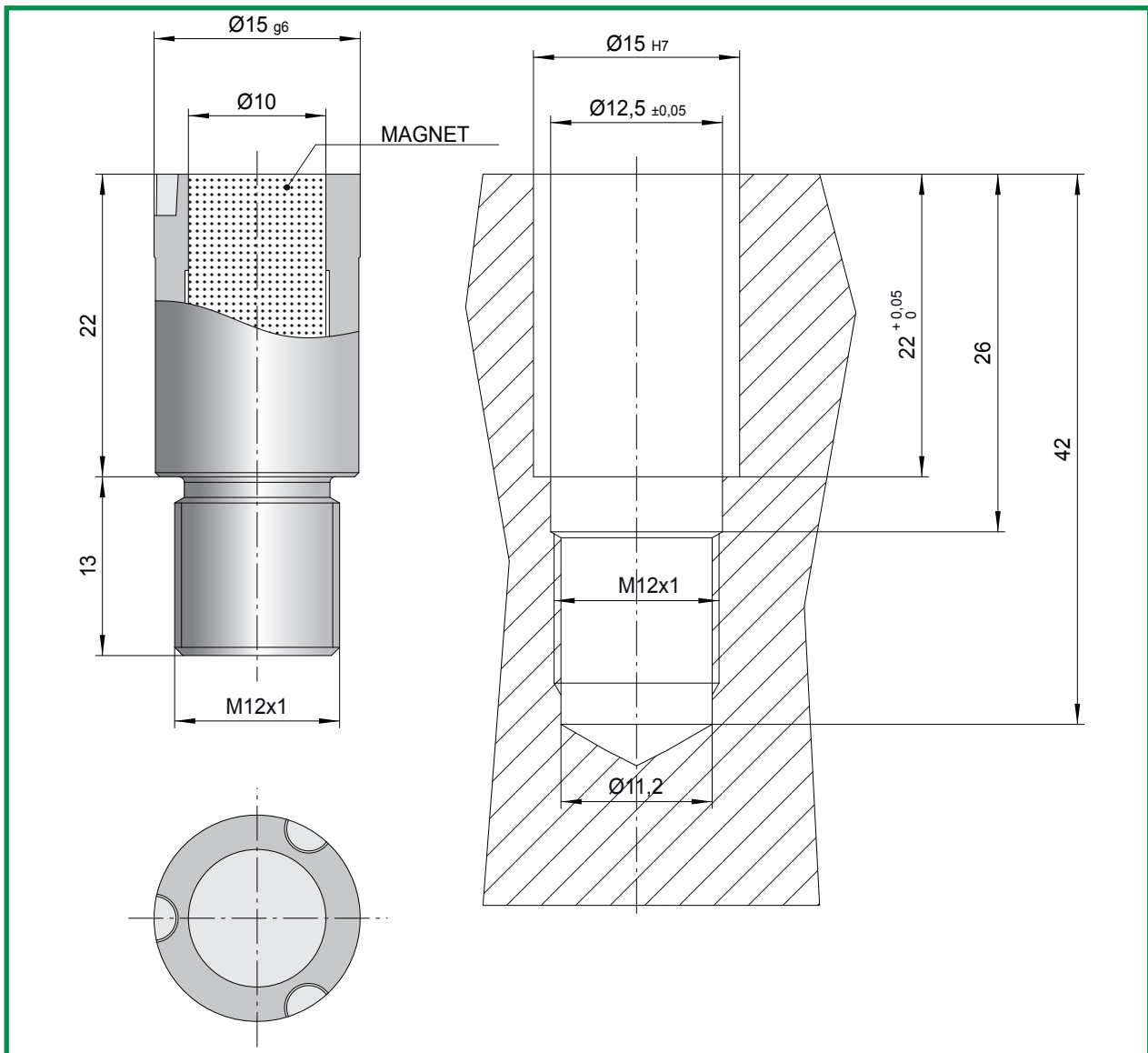

CODE: **MS-5**

CHARACTERISTICS

- 1) EASY TO APPLY;
- 2) MAGNET FORCE 5 KgfN.

KEY FOR SUPPORT MAGNET

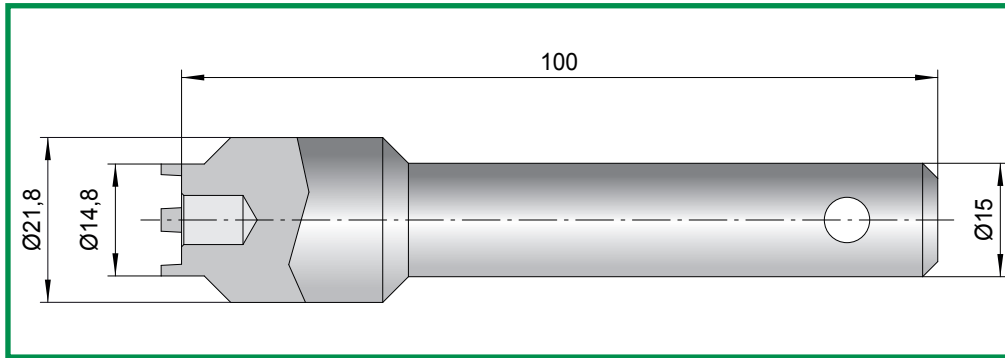

CODE: **MS-C1**

CODE	MS-5
MS-C1	✓



ERMANNNO BALZI

Viale Enrico Mattei, 13
25080 Mazzano (Brescia)
Tel: +39 0302120868
E-mail: info@ermannobalzi.com