

# ADJUSTABLE SLIDE RETAINER

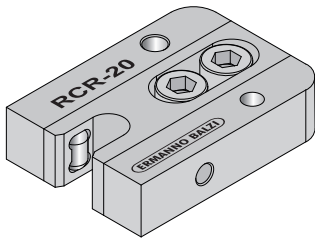

CODE: **RCR**

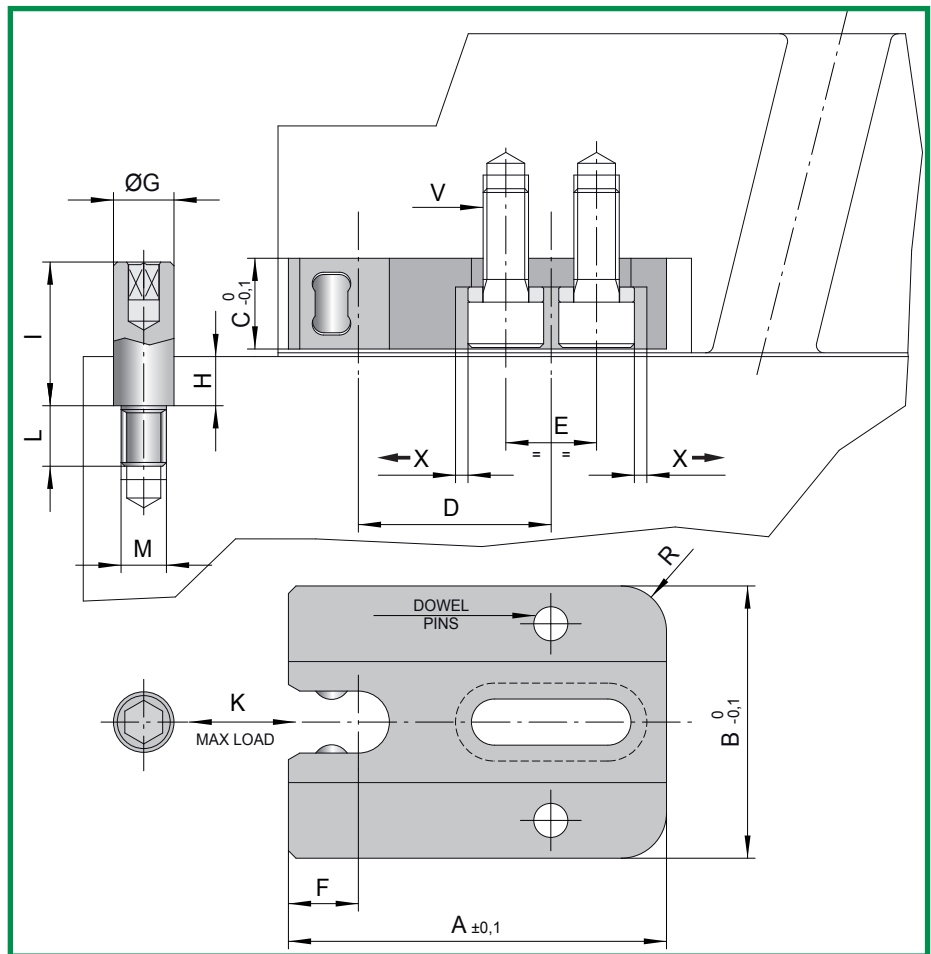

## WAYS OF APPLICATION

### Adjustable

Positioning the screws with interaxis **E1**, it is possible to adjust the device position according to the quote **X**.

In this case we recommend to apply, after the setting, at least a positioning pin, that allows to maintain the position in case of disassembly.

### Fixed

Positioning the screws with interaxis **E2** the holder is fixed.

CODE	A	B	C	D	E1	E2	F	G	H	I	L	M	V	X	R	K
RCR-10	38	24	10	18,7	10	12	7,3	6	6	15	6	M5	M5x15	1	4	10Kg
RCR-20	50	36	12	25,5	12	15	9,2	8	8	19	8	M6	M6x15	1,5	6	20Kg
RCR-40	64	46	16	33	15	19	12	12	8	23	10	M10	M8x20	2	8	40Kg

## CHARACTERISTICS

- 1) POSSIBILITY OF REGULATION;
- 2) HIGH LOAD CAPACITY;
- 3) LACK OF WEAR (guaranteed by hooking by rolls);
- 4) PROTECTED HOOKING MECHANISM (no fear of dirt).

**ERMANN BALZI**

**PLATES RETAINING**

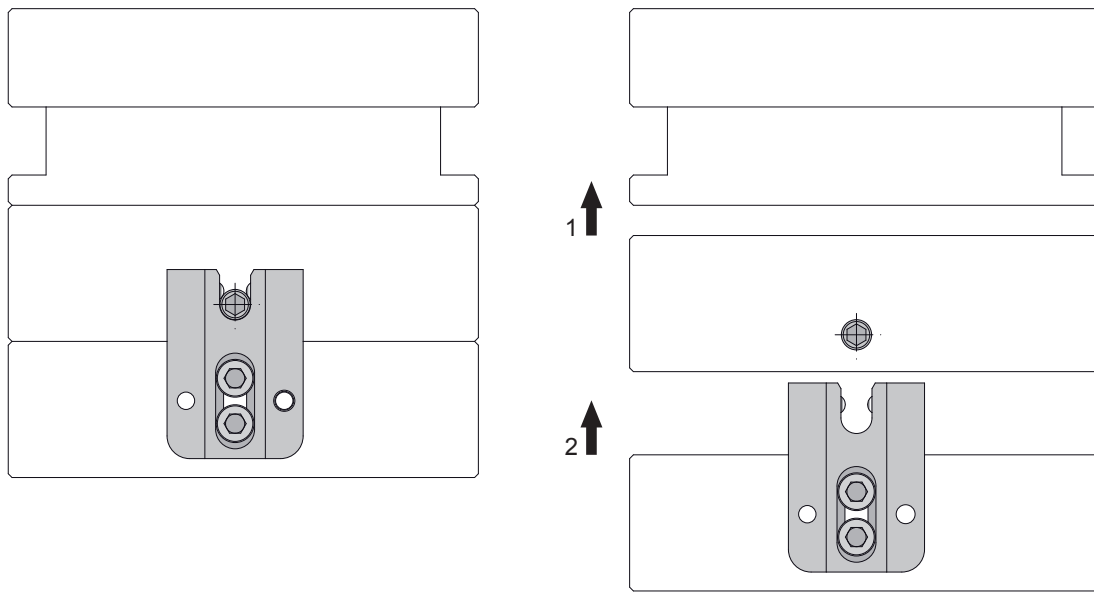

**SLIDERS RETAINING**

